



LEGEND:

-  COMMUNITY ENTRY
-  MAIN ENTRY
-  STUDENT ENTRY



NORTH RIDGEVILLE ACADEMIC CENTER SITE PLAN



NORTH RIDGEVILLE ACADEMIC CENTER

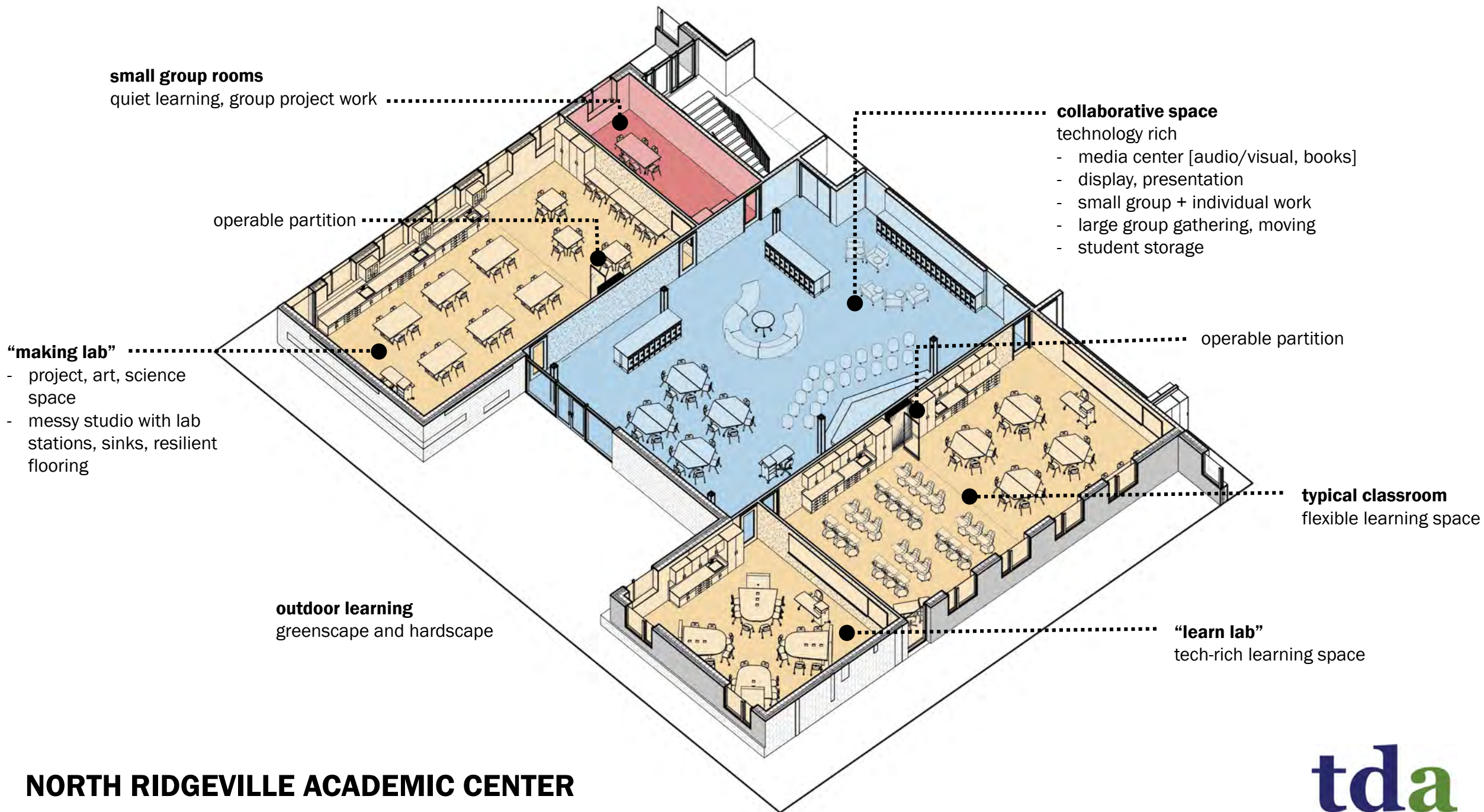

**NORTH RIDGEVILLE ACADEMIC CENTER
ELEMENTARY LEARNING COMMUNITY**

collaborative space

technology rich

- media center [audio/visual, books]
- display, presentation
- small group + individual work
- large group gathering, moving
- student storage

outdoor learning

greenscape and hardscape

“learn lab”

tech-rich learning space

operable partition

operable partition

small group rooms

quiet learning, group project work





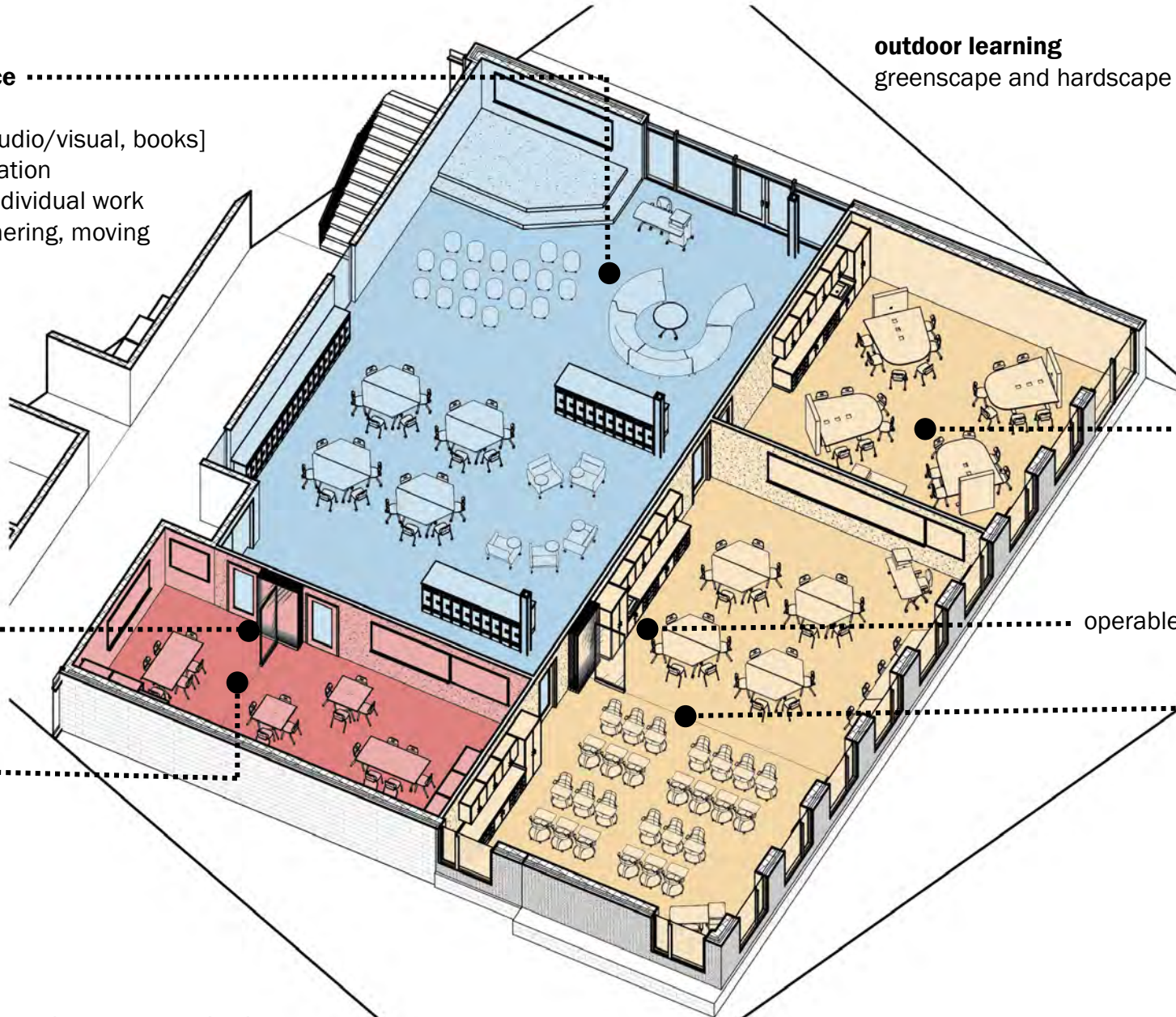



typical classroom

flexible learning space



**NORTH RIDGEVILLE ACADEMIC CENTER
MIDDLE SCHOOL LEARNING COMMUNITY**





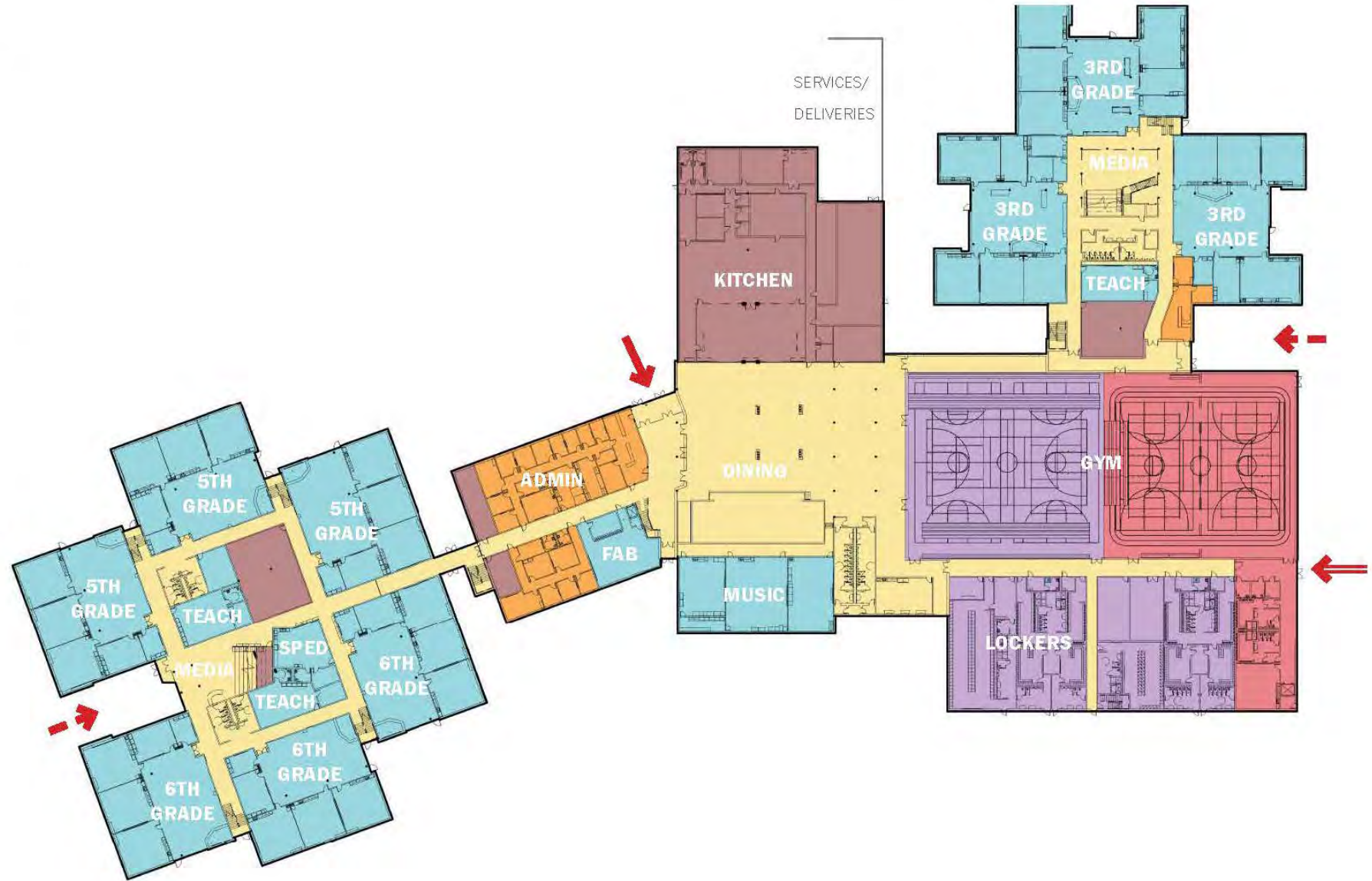



LEGEND:

| | |
|---|------------------------|
|  | ACADEMIC |
|  | STUDENT DINING/STAGE |
|  | ADMINISTRATION |
|  | PE/ATHLETICS |
|  | FOOD/BUILDING SERVICES |
|  | COMMUNITY GYMNASIUM |
|  | COMMUNITY ENTRY |
|  | MAIN ENTRY |
|  | STUDENT ENTRY |



**NORTH RIDGEVILLE ACADEMIC CENTER
FIRST FLOOR PLAN**





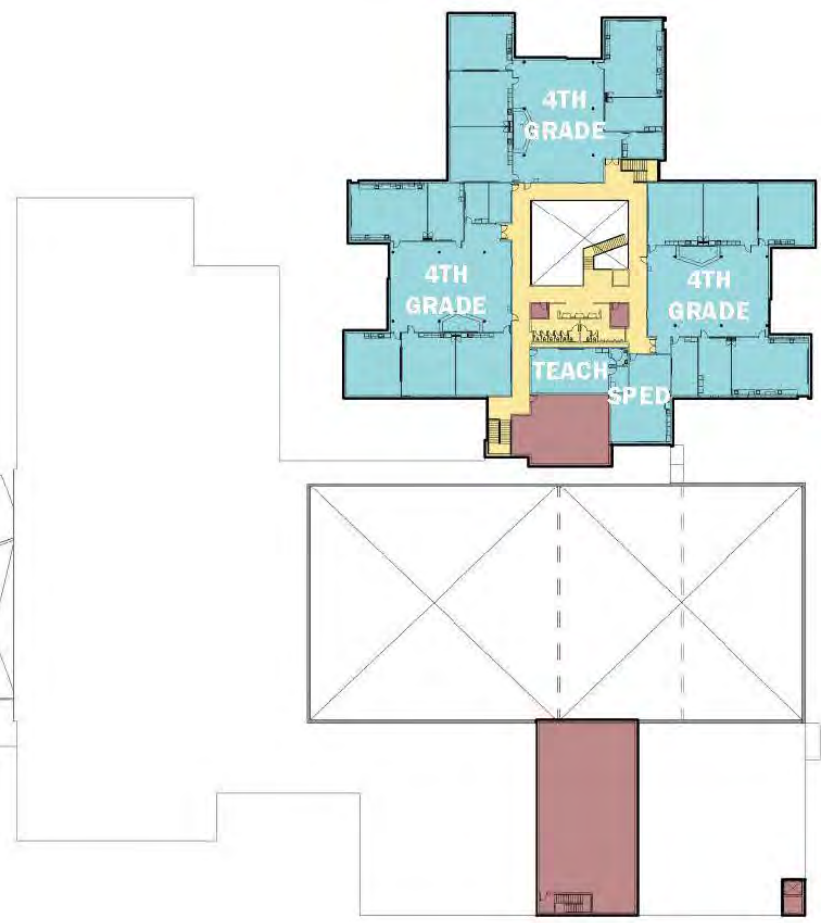
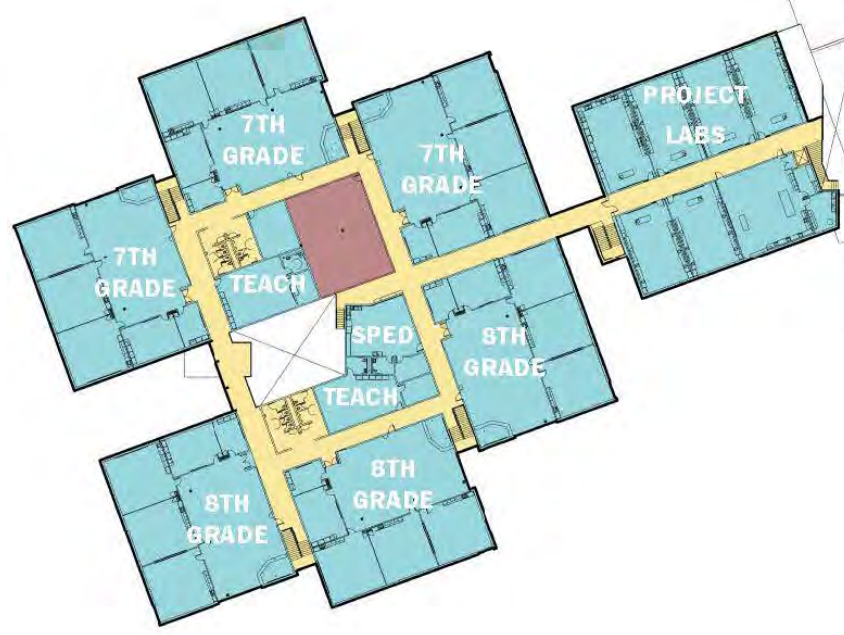





LEGEND:

| | |
|---|------------------------|
|  | ACADEMIC |
|  | STUDENT DINING/STAGE |
|  | ADMINISTRATION |
|  | PE/ATHLETICS |
|  | FOOD/BUILDING SERVICES |
|  | COMMUNITY GYMNASIUM |
|  | COMMUNITY ENTRY |
|  | MAIN ENTRY |
|  | STUDENT ENTRY |



**NORTH RIDGEVILLE ACADEMIC CENTER
SECOND FLOOR PLAN**

LEGEND:

| | |
|---|-------------------|
|  | COLLABORATIVE |
|  | LEARNING LAB |
|  | SMALL GROUP |
|  | MEDIA |
|  | TEACHERS |
|  | SPEC ED |
|  | BUILDING SERVICES |
|  | BUILDING SERVICES |
|  | MAIN ENTRY |
|  | STUDENT ENTRY |



**NORTH RIDGEVILLE ACADEMIC CENTER
3-4 WING: FIRST FLOOR PLAN**

LEGEND:

| | |
|---|-------------------|
|  | COLLABORATIVE |
|  | LEARNING LAB |
|  | SMALL GROUP |
|  | MEDIA |
|  | TEACHERS |
|  | SPEC ED |
|  | BUILDING SERVICES |
|  | MAIN ENTRY |
|  | STUDENT ENTRY |



**NORTH RIDGEVILLE ACADEMIC CENTER
5-8 WING: FIRST FLOOR PLAN**